

**RESOLUTION NO. ~~12-48~~**  
**RESOLUTION CREATING RURAL SPECIAL**  
**IMPROVEMENT MAINTENANCE DISTRICT TO BE KNOWN AS R.S.I.D. #804M**  
**(MONTANA MEADOWS SUBDIVISION #2 - ROADS)**

WHEREAS, a Petition signed by more than sixty percent (60%) of the Freeholders of the proposed district has been submitted to the Board of County Commissioners for creation of a rural special improvement maintenance district (RSID) for the maintenance of roads within the proposed boundaries (excluding Buffalo Horn Dr) as shown in Exhibit A (map) in Yellowstone County, Montana; and,

WHEREAS, the legal descriptions of properties located within the proposed boundaries of the district are described in Exhibit B; and,

WHEREAS, all of the costs of the district shall be assessed equally on a per lot method for existing and future lots (Exhibit D); and,

WHEREAS, the cost estimate as shown in Exhibit C is only an estimate of annual costs and is subject to cost fluctuations due to maintenance utilization levels and changes in material and labor costs of performing necessary maintenance; and,

WHEREAS, the property assessment amount is subject to adjustment and will be established annually by the Board of County Commissioners; and,

WHEREAS, the district shall be considered a district to exist perpetually unless included within another district providing the same services or assumed by a municipality.

NOW, THEREFORE, BE IT RESOLVED by the Board of County Commissioners of Yellowstone County, Montana, deeming the public interest or convenience require, and having received an adequate Petition for the creation of the rural special improvement maintenance district, intends to create the following described Rural Special Improvement Maintenance District:

1. **NUMBER OF DISTRICT.** The Rural Special Improvement Maintenance District shall be designated as District No. 804M.
2. **DESCRIPTION OF DISTRICT.** The exterior boundaries of the District are shown in Exhibit A and and listed by tax code in Exhibit B.
3. **DESCRIPTION OF IMPROVEMENTS, DESCRIPTION OF MAINTENANCE, METHOD OF ASSESSMENT AND ESTIMATED COSTS.** Assessments collected on behalf of this district shall be used for the maintenance of roads located within the district, (excluding Buffalo Horn Dr.), as estimated in Exhibit C. All of the costs of the district shall be assessed equally on a per lot method for existing and future lots (Exhibit D).
4. **DURATION.** The district shall be deemed to be perpetual in nature unless absorbed and replaced by another district or municipality.

5. **AD HOC COMMITTEE.** The Commissioners desire that an Ad Hoc Committee be appointed to make recommendations to the Commissioners with regard to the need for assessments to be made for maintenance, the amount of assessments, and how the assessments should be spent. The Commissioners initially appoint the attached list of individuals who are willing to serve on the Ad Hoc Committee (Exhibit E).

PASSED AND ADOPTED by the Board of County Commissioners of Yellowstone County, Montana, this 5<sup>th</sup> day of June, 2012.

BOARD OF COUNTY COMMISSIONERS  
YELLOWSTONE COUNTY, MONTANA

  
John Ostlund, Chairman

  
Bill Kennedy, Member

  
James E. Reno, Member

(SEAL)  
ATTEST:

  
Jeff Martin, Clerk & Recorder  
Yellowstone County, Montana

# EXHIBIT A

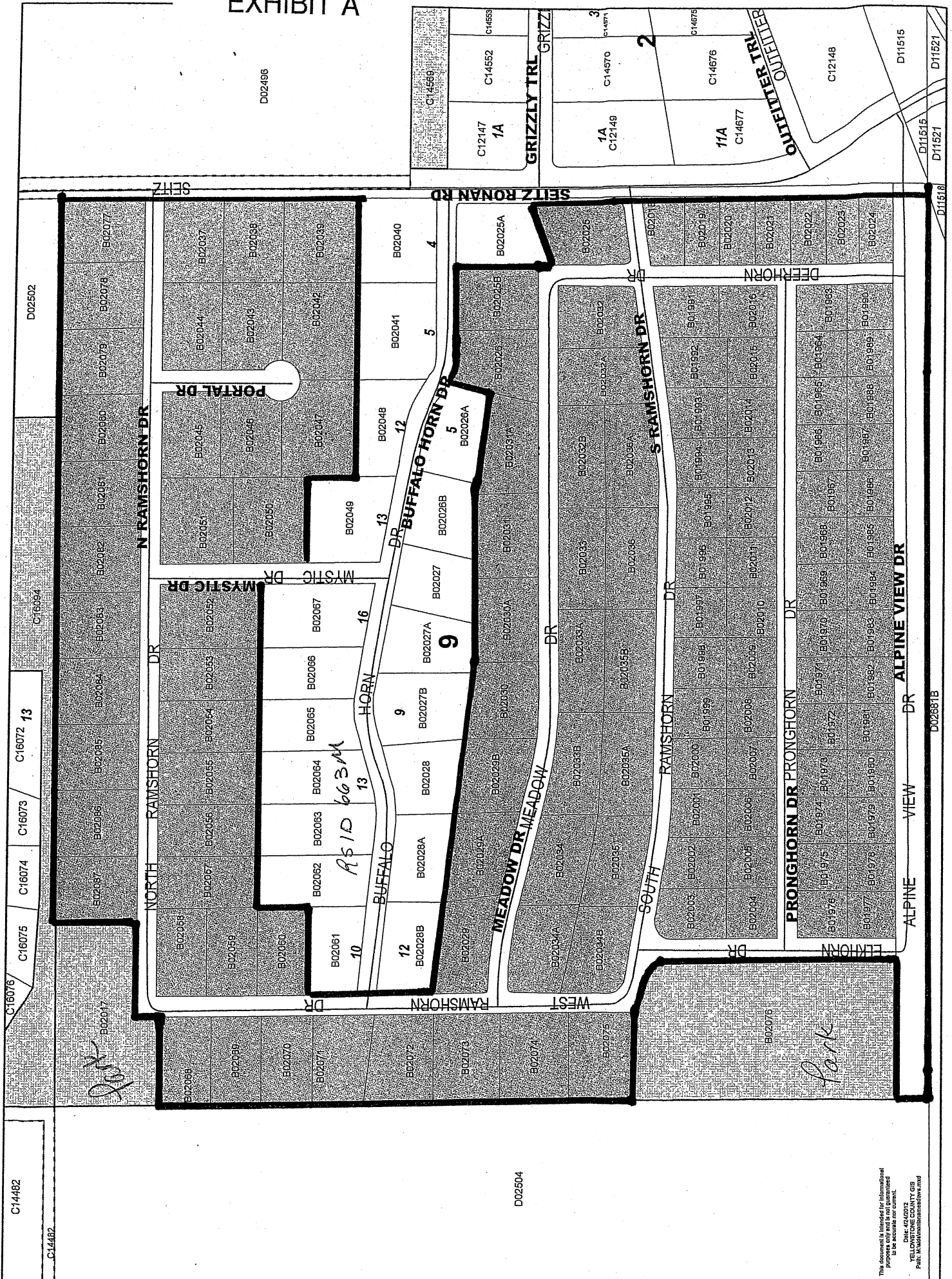

This document is intended for informational purposes only and is not guaranteed to be accurate nor current.  
 PREPARED BY: YELLAND COUNTY GIS  
 DATE: 10/20/2010  
 PATH: M:\GIS\workspace\yelland\mirenowe.mxd

C14482

C14482

C16075

C16074

C16073

C16072 13

C16076

C16074

C16073

C16072 13

D02502

D02466

D02504

C12147 1A

C14552

C14560

C14570

C14676

C14677

C12148

D11515

D11521

D11515

D11521

D11515

D11521

D11515

D11521

D11515

D11521

D11515

D11521

D11515

D11521

D11515

D11521

D11515

D11521

D11515

D11521

D11515

D11521

D11515

D11521

D11515

D11521

**EXHIBIT B**  
**Proposed RSID 804M Property Legal Descriptions**

	<u>TAX_ID</u>	<u>BLK_NUM</u>	<u>LOT_NUM</u>	<u>SUBD</u>
1	B01963	1	1	MONTANA MEADOWS SUB
2	B01964	1	2	MONTANA MEADOWS SUB
3	B01965	1	3	MONTANA MEADOWS SUB
4	B01966	1	4	MONTANA MEADOWS SUB
5	B01967	1	5	MONTANA MEADOWS SUB
6	B01968	1	6	MONTANA MEADOWS SUB
7	B01969	1	7	MONTANA MEADOWS SUB
8	B01970	1	8	MONTANA MEADOWS SUB
9	B01971	1	9	MONTANA MEADOWS SUB
10	B01972	1	10	MONTANA MEADOWS SUB
11	B01973	1	11	MONTANA MEADOWS SUB
12	B01974	1	12	MONTANA MEADOWS SUB
13	B01975	1	13	MONTANA MEADOWS SUB
14	B01976	1	14	MONTANA MEADOWS SUB
15	B01977	1	15	MONTANA MEADOWS SUB
16	B01978	1	16	MONTANA MEADOWS SUB
17	B01979	1	17	MONTANA MEADOWS SUB
18	B01980	1	18	MONTANA MEADOWS SUB
19	B01981	1	19	MONTANA MEADOWS SUB
20	B01982	1	20	MONTANA MEADOWS SUB
21	B01983	1	21	MONTANA MEADOWS SUB
22	B01984	1	22	MONTANA MEADOWS SUB
23	B01985	1	23	MONTANA MEADOWS SUB
24	B01986	1	24	MONTANA MEADOWS SUB
25	B01987	1	25	MONTANA MEADOWS SUB
26	B01988	1	26	MONTANA MEADOWS SUB
27	B01989	1	27	MONTANA MEADOWS SUB
28	B01990	1	28	MONTANA MEADOWS SUB
29	B01991	2	1	MONTANA MEADOWS SUB
30	B01992	2	2	MONTANA MEADOWS SUB
31	B01993	2	3	MONTANA MEADOWS SUB
32	B01994	2	4	MONTANA MEADOWS SUB
33	B01995	2	5	MONTANA MEADOWS SUB
34	B01996	2	6	MONTANA MEADOWS SUB
35	B01997	2	7	MONTANA MEADOWS SUB
36	B01998	2	8	MONTANA MEADOWS SUB
37	B01999	2	9	MONTANA MEADOWS SUB
38	B02000	2	10	MONTANA MEADOWS SUB
39	B02001	2	11	MONTANA MEADOWS SUB
40	B02002	2	12	MONTANA MEADOWS SUB
41	B02003	2	13	MONTANA MEADOWS SUB
42	B02004	2	14	MONTANA MEADOWS SUB
43	B02005	2	15	MONTANA MEADOWS SUB
44	B02006	2	16	MONTANA MEADOWS SUB
45	B02007	2	17	MONTANA MEADOWS SUB
46	B02008	2	18	MONTANA MEADOWS SUB
47	B02009	2	19	MONTANA MEADOWS SUB
48	B02010	2	20	MONTANA MEADOWS SUB
49	B02011	2	21	MONTANA MEADOWS SUB
50	B02012	2	22	MONTANA MEADOWS SUB
51	B02013	2	23	MONTANA MEADOWS SUB
52	B02014	2	24	MONTANA MEADOWS SUB
53	B02015	2	25	MONTANA MEADOWS SUB
54	B02016	2	26	MONTANA MEADOWS SUB
55	B02018	3	1	MONTANA MEADOWS SUB
56	B02019	3	2	MONTANA MEADOWS SUB
57	B02020	3	3	MONTANA MEADOWS SUB
58	B02021	3	4	MONTANA MEADOWS SUB
59	B02022	3	5	MONTANA MEADOWS SUB
60	B02023	3	6	MONTANA MEADOWS SUB
61	B02024	3	7	MONTANA MEADOWS SUB
62	B02025	9	1	MONTANA MEADOWS SUB

**EXHIBIT B**  
**Proposed RSID 804M Property Legal Descriptions**

63	B02025B	9	3	MONTANA MEADOWS SUB
64	B02026	9	4	MONTANA MEADOWS SUB
65	B02029	9	13	MONTANA MEADOWS SUB
66	B02029A	9	14	MONTANA MEADOWS SUB
67	B02029B	9	15	MONTANA MEADOWS SUB
68	B02030	9	16	MONTANA MEADOWS SUB
69	B02030A	9	17	MONTANA MEADOWS SUB
70	B02031	9	18	MONTANA MEADOWS SUB
71	B02031A	9	19	MONTANA MEADOWS SUB
72	B02032	10	1	MONTANA MEADOWS SUB
73	B02032A	10	2	MONTANA MEADOWS SUB
74	B02032B	10	3	MONTANA MEADOWS SUB
75	B02033	10	4	MONTANA MEADOWS SUB
76	B02033A	10	5	MONTANA MEADOWS SUB
77	B02033B	10	6	MONTANA MEADOWS SUB
78	B02034	10	7	MONTANA MEADOWS SUB
79	B02034A	10	8	MONTANA MEADOWS SUB
80	B02034B	10	9	MONTANA MEADOWS SUB
81	B02035	10	10	MONTANA MEADOWS SUB
82	B02035A	10	11	MONTANA MEADOWS SUB
83	B02035B	10	12	MONTANA MEADOWS SUB
84	B02036	10	13	MONTANA MEADOWS SUB
85	B02036A	10	14	MONTANA MEADOWS SUB
86	B02037	5	1	MONTANA MEADOWS SUB
87	B02038	5	2	MONTANA MEADOWS SUB
88	B02039	5	3	MONTANA MEADOWS SUB
89	B02042	5	6	MONTANA MEADOWS SUB
90	B02043	5	7	MONTANA MEADOWS SUB
91	B02044	5	8	MONTANA MEADOWS SUB
92	B02045	5	9	MONTANA MEADOWS SUB
93	B02046	5	10	MONTANA MEADOWS SUB
94	B02047	5	11	MONTANA MEADOWS SUB
95	B02050	5	14	MONTANA MEADOWS SUB
96	B02051	5	15	MONTANA MEADOWS SUB
97	B02052	6	1	MONTANA MEADOWS SUB
98	B02053	6	2	MONTANA MEADOWS SUB
99	B02054	6	3	MONTANA MEADOWS SUB
100	B02055	6	4	MONTANA MEADOWS SUB
101	B02056	6	5	MONTANA MEADOWS SUB
102	B02057	6	6	MONTANA MEADOWS SUB
103	B02058	6	7	MONTANA MEADOWS SUB
104	B02059	6	8	MONTANA MEADOWS SUB
105	B02060	6	9	MONTANA MEADOWS SUB
106	B02068	7	1	MONTANA MEADOWS SUB
107	B02069	7	2	MONTANA MEADOWS SUB
108	B02070	7	3	MONTANA MEADOWS SUB
109	B02071	7	4	MONTANA MEADOWS SUB
110	B02072	7	5	MONTANA MEADOWS SUB
111	B02073	7	6	MONTANA MEADOWS SUB
112	B02074	7	7	MONTANA MEADOWS SUB
113	B02075	7	8	MONTANA MEADOWS SUB
114	B02077	8	1	MONTANA MEADOWS SUB
115	B02078	8	2	MONTANA MEADOWS SUB
116	B02079	8	3	MONTANA MEADOWS SUB
117	B02080	8	4	MONTANA MEADOWS SUB
118	B02081	8	5	MONTANA MEADOWS SUB
119	B02082	8	6	MONTANA MEADOWS SUB
120	B02083	8	7	MONTANA MEADOWS SUB
121	B02084	8	8	MONTANA MEADOWS SUB
122	B02085	8	9	MONTANA MEADOWS SUB
123	B02086	8	10	MONTANA MEADOWS SUB
124	B02087	8	11	MONTANA MEADOWS SUB

\*\* Final figures will come from Engineer

### EXHIBIT C

#### ESTIMATED ANNUAL MAINTENANCE COST

see attached

##### FALL MAINTENANCE:

ACTIVITY	ESTIMATED COST
	\$
	\$

##### WINTER MAINTENANCE:

ACTIVITY	ESTIMATED COST
	\$
	\$

##### SPRING MAINTENANCE:

ACTIVITY	ESTIMATED COST
	\$
	\$

##### SUMMER MAINTENANCE:

ACTIVITY	ESTIMATED COST
Sub-surface areas, cracks, holes,	\$ 150 per lot
Weeds/tree obstructing toward avenues, chip sealing (Fn 4-7 yrs)	\$ per annum

TOTAL ESTIMATED ANNUAL MAINTENANCE COST: \$18,600

# EXHIBIT D

## METHOD OF ASSESSMENT

CHOOSE A METHOD OF ASSESSMENT:

Square Footage

Equal Amount

Front Footage

Other (Describe)

---

---

---

---

---

---

---

# EXHIBIT E

## PROPOSED RURAL SPECIAL IMPROVEMENT DISTRICT RECOMMENDATIONS FOR AD HOC COMMITTEE

NAME	TELEPHONE NUMBER
1. <u>Marlene M. Hanify</u> (Chairman) Printed Name	<u>(406) 628-7991</u>
<u>Marlene M Hanify</u> Signature	
2. <u>John A. Van Aken</u> Printed Name	<u>406-690-5355</u>
<u>John A. Van Aken</u> Signature	
3. <u>Colleen Boeshans</u> Printed Name	<u>406-628-8496</u>
<u>Colleen Boeshans</u> Signature	
4. <u>Nathan Boeshans</u> Printed Name	<u>406-628-8496</u>
<u>Nathan Boeshans</u> Signature	
5. <u>John Thomas Kress</u> Printed Name	<u>406-628-6921</u>
<u>John Thomas Kress</u> Signature	



EXHIBIT E

PROPOSED RURAL SPECIAL IMPROVEMENT DISTRICT  
RECOMMENDATIONS FOR AD HOC COMMITTEE

NAME

TELEPHONE NUMBER

6. Joseph R Moore  
Printed Name 406-628-7419  
Joseph R Moore  
Signature
7. Michael D DuFresne  
Printed Name 406-628-1149  
Michael D DuFresne  
Signature
8. ARleen A. Gwenther  
Printed Name 406-628-8256  
Arleen A Gwenther  
Signature
9. Tredy Staudihar  
Printed Name 406-628-2449  
Tredy Staudihar  
Signature
10. \_\_\_\_\_  
Printed Name \_\_\_\_\_  
\_\_\_\_\_  
Signature
11. \_\_\_\_\_  
Printed Name \_\_\_\_\_  
\_\_\_\_\_  
Signature